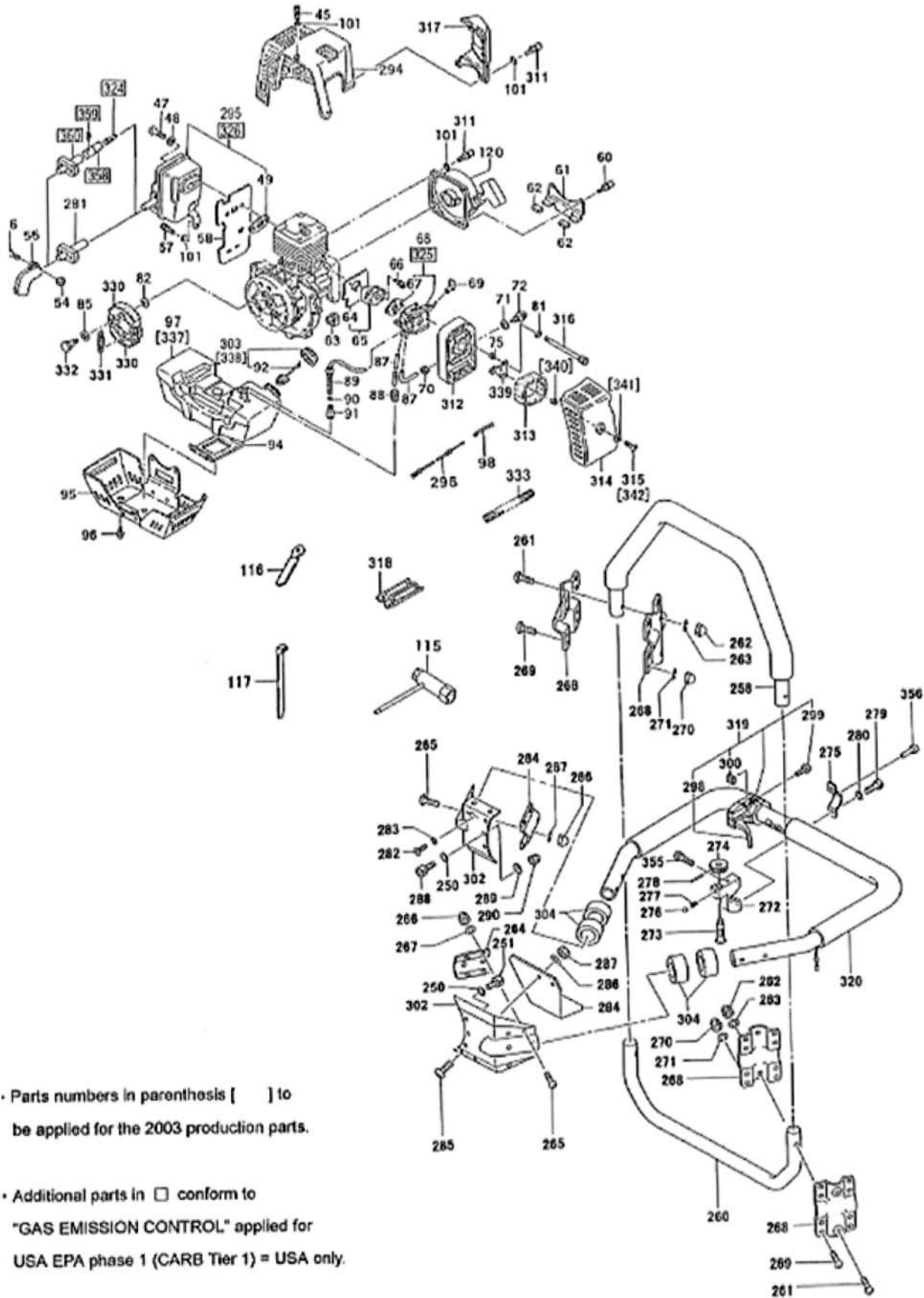

FIG.2 ENGINE COMPONENTS – EXPLODED DIAGRAM DRAWING

• Parts numbers in parenthesis [] to be applied for the 2003 production parts.

• Additional parts in □ conform to "GAS EMISSION CONTROL" applied for USA EPA phase 1 (CARB Tier 1) = USA only.

FIG.2 ENGINE COMPONENTS – EXPLODED DIAGRAM DRAWING
Engine components - Parts List

Index No	PART NAME	Number Required	Index No	PART NAME	Number Required
045	HEX. HOLE BOLT 5x12S	1	273	VALVE, ADJUSTMENT	1
047	HEX. HOLE BUTTON SCREW 6x65	2	274	BUTTON, ADJUSTMENT	1
048	WASHER 6	2	275	BRACKET, ADJUSTMENT	1
049	MUFFLER GASKET	1	276	BALL, ADJUSTMENT 4 IN DIA.	1
054	U NUT 4	1	277	SPRING, ADJUSTMENT S3.8x0.6	1
055	TAIL PIPE COMPLETE	1	278	FIXED PIN SP2.5x16 FOR ADJUST BUTTON	1
056	SCREW 4x12	1	279	HEX. CAP BUTTON BOLT M5x12	1
057	HEX. HOLE BOLT 5x12S	1	280	WASHER M5, SPRING	2
058	HEAT SHIELD	1	281	BRACKET FOR TAIL PIPE	2
060	HEX. HOLE BOLT 5X20PS	2	282	HEX. CAP BUTTON BOLT M6x12	1
061	TANK BRACKET	1	283	WASHER 2H-M6, JAGGED SPRING	2
062	FUEL TANK CUSHION RUBBER	2	284	COVER FOR WIRES	2
063	FUEL TANK CUSHION RUBBER	2	285	HEX. CAP BUTTON BOLT M6x16	2
064	INLET MANIFOLD GASKET	1	286	WASHER M6, SPRING	2
065	GARB. INSULATOR SET(INDEX NO.64, 65)	1	287	HEX NUT M6	2
066	HEX. HOLE BOLT 5X25WS	2	288	HEX. CAP THREAD-THROUGH BOLT M6x22	3
067	CARBURETOR GASKET	1	289	WASHER 2H-M6, JAGGED SPRING	3
068	CARBURETOR SET (INDEX NO.67, 68)	1	290	HEX U-NUT M6	3
069	CHOKE LEVER 1565-30	1	294	MUFFLER PROTECTOR	1
070	NUT 10	1	295	MUFFLER SET(INDEX NO.49,295)	1
071	INNER TOOTHED WASHER 10	1	296	THROTTLE WIRE COMPLETE	1
072	PRIMING PUMP COMPLETE	1	298	THROTTLE ARM	1
075	COLLAR 5.8	2	299	5x20 SCREW	1
081	S. WASHER 5	2	300	SPECIAL NUT M5	1
082	CLUTCH WASHER B 1.6	2	302	HANDLE BRACKET	2
085	WAVE WASHER 10	2	303	TANK CAP ASS'Y(INDEX NO.92,303)	1
087	FUEL PIPE 2.5X4X90	2	304	HANDLE DUMPER RUBBER	4
088	RETURN GROMMET	1	311	HEX HOLE BOLT 5x30S	2
089	FUEL PIPE ASS'Y 3x5x230	1	312	CLEANER BODY	1
090	CLIP, 6.3 DIA.	1	313	CLEANER SPONGE	1
091	PUMP FILTER BODY ASS'Y	1	314	CLEANER CAP	1
092	TANK CAP CHAIN	1	315	BOLT, COVER FASTENING	1
094	CUSHION RUBBER	1	316	HEX HOLE BOLT 5x60	2
095	TANK HOLDING METAL COMPLETE	1	317	AIR COVER	1
096	HEX. HOLE BOLT 5x15WS	2	318	CONNECTOR CASE	1
097	FUEL TANK, VERMILLION	1	319	THROTTLE LEVER ASS'Y (INDEX NO.298,299,300 AND 319)	1
098	ADJUST SPRING	1	320	HANDLE FRAME ASS'Y	1
101	WASHER 5	1	324	SPARK ARRESTER COMPLETE (USA MARKET)	1
115	COMBI. BOX SPANNER 10x19, PLUS	1	325	CARBURETOR SET (USA MARKET)	1
116	CORD CLAMP COMPLETE	1	326	MUFFLER SET (USA MARKET)	1
117	CORD CLAMP	1	330	CLUTCH ARM COMPLETE	2
120	RECOIL STARTER BODY ASS'Y	1	331	CLUTCH SPRING	1
250	WASHER, SPRING M6	6	332	CLUTCH STEP BOLT	2
251	HEX. CAP BUTTON BOLT M6X12	3	333	SPRIT PROTECTION TUBE 10x200L	1
258	ANTI-VIBRATION SUPPORT HANDLE RUBBER COVERED	1	337	TANK	1
260	PIPE FOR PROTECTING TANK	1	338	TANK CAP D-ASS'Y	1
261	HEX. CAP BUTTON BOLT M5x35	4	339	BLOW OVER CHECK BOARD	1
262	HEX. U-NUT M5	4	340	COLLAR 10	1
263	WASHER M5, SPRING	4	341	WASHER 1.6, BRAKE SHANK	1
264	PLATE FOR HANDLE	2	342	BOLT, COVER FASTENING	1
265	HEX. CAP BUTTON BOLT M5x16	8	358	TAIL PIPE (USA MARKET)	1
266	HEX U-NUT M5	8	359	HEX. HOLE SCREW M6X6 (USA MARKET)	2
267	WASHER M5, SPRING	8	360	TAIL PIPE BRACKET (USA MARKET)	1
268	BRACKET FOR SUPPORT HANDLE	4			
269	HEX. CAP BUTTON BOLT M5x14	16			
270	HEX U-NUT M5	16			
271	WASHER M5, SPRING	16			
272	ADJUSTMENT BASE COMPLETE (INDEX NO 272,273,274,276,277,278 AND 355)	1			